

Brass Push Fittings

全铜快插接头

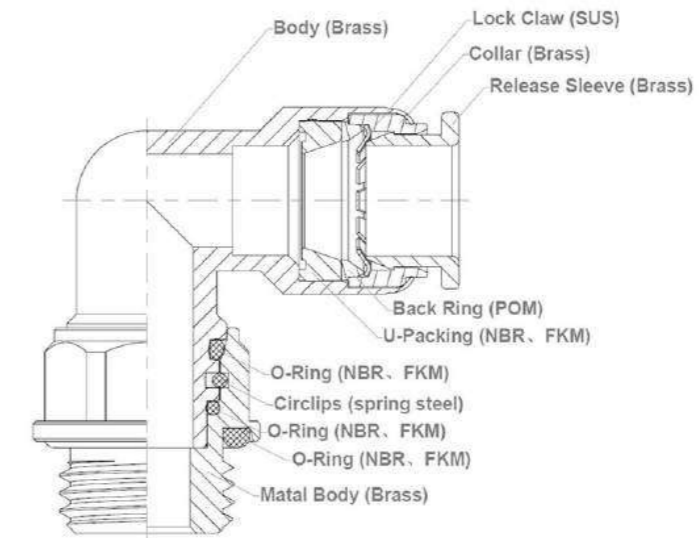

Structural Diagram



Features/ 特征

- * Double O-Ring design make sure the 100% sealing
- * The collet made in Stainless Steel ensure the perfect tube clamping with every kinds of materials without damage the surface
- * The connection between the tube and the fittings ensure a total tightness even in severe conditions such as impact and vibration
- * The particular geometric shape of the seals ensure the perfect tightness even with vacuum.

Specifications/ 技术规格

Applicable Fluid Type	Air, Water(No Drinking Water), Vacuum	
Working Pressure Range	-14 ~225 PSI	-0.99~15Bar
Working Temperature Range	-4 °F ~160 °F	-15°C ~71°C
Vacuum Rating	to 28"Hg	
Recommended Tubings	PA11, PA12, PA6, PE, PU, FEP, PFA	

Tube Outside Diameter You Can Choose As Follows:

您可以选择的气管外径尺寸如下:

	Metric Size/ 公制尺寸					Inch Size/ 英制尺寸				
Code No. 代码	4	6	8	10	12	5/32	1/4	5/16	3/8	1/2
Tube Outside Dia 气管外径	φ4	φ6	φ8	φ10	φ12	φ5/32	φ1/4	φ5/16	φ3/8	φ1/2

Thread Size For Your Choice As Follows:

您可以选择的螺纹尺寸如下:

Code No. 代码					
M5	M6	01	02	03	04
Thread Size 螺纹尺寸					
M5	M6	1/8	1/4	3/8	1/2

Brass Push Fittings

全铜快插接头

MPC-BSPT

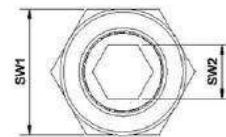
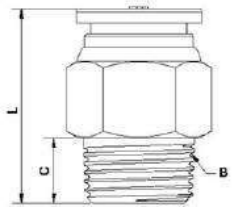

Item Code	Tube OD	BSPT		L	SW1	SW2
	Tube φ	B	C			
MPC3-01	3	1/8	7.5	19.5	10	2
MPC3-02	3	1/4	9	18.5	14	2
MPC3-03	3	3/8	10	20.5	17	2
MPC3-04	3	1/2	13	23.5	21	2
MPC4-01	4	1/8	7.5	19.5	10	3
MPC4-02	4	1/4	9	18.5	14	3
MPC6-01	6	1/8	7.5	19.7	12	5
MPC6-02	6	1/4	9	20.2	14	5
MPC6-03	6	3/8	10	21.2	17	5
MPC6-04	6	1/2	13	24.2	21	5
MPC8-01	8	1/8	7.5	24	14	5
MPC8-02	8	1/4	9	22.5	14	6
MPC8-03	8	3/8	10	21.2	17	6
MPC8-04	8	1/2	13	24.2	21	6
MPC10-01	10	1/8	7.5	26.5	17	5
MPC10-02	10	1/4	9	26.5	17	6
MPC10-03	10	3/8	10	26.2	17	8
MPC10-04	10	1/2	13	24.7	21	8
MPC12-02	12	1/4	9	30.2	19	6
MPC12-03	12	3/8	10	28.3	19	8
MPC12-04	12	1/2	13	28.7	21	8

MPC-BSPP

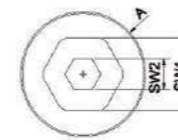
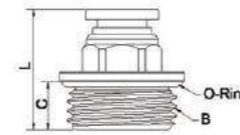

Item Code	Tube OD	BSPP			L	SW1	SW2
	Tube φ	A φ	B	C			
MPC3-G01	3	14	1/8	5.5	18.5	10	2
MPC3-G02	3	17	1/4	6.9	18.5	10	2
MPC4-G01	4	14	1/8	5.5	18.5	10	3
MPC4-G02	4	17	1/4	6.9	18.5	10	3
MPC6-G01	6	14	1/8	5.5	18.7	12	5
MPC6-G02	6	17	1/4	6.9	20.2	12	5
MPC6-G03	6	19	3/8	8.2	20.2	12	5
MPC6-G04	6	24	1/2	9.2	21.2	12	5
MPC8-G01	8	14	1/8	5.5	23	14	5
MPC8-G02	8	17	1/4	6.9	21.4	14	6
MPC8-G03	8	19	3/8	8.2	22.2	14	6
MPC8-G04	8	24	1/2	9.2	21.7	14	6
MPC10-G01	10	14	1/8	5.5	25.4	17	5
MPC10-G02	10	17	1/4	6.9	26.7	17	6
MPC10-G03	10	19	3/8	8.2	25.2	17	8
MPC10-G04	10	24	1/2	9.2	22.7	17	8
MPC12-G02	12	17	1/4	6.9	28.7	19	6
MPC12-G03	12	19	3/8	8.2	29.7	19	8
MPC12-G04	12	24	1/2	9.2	26.3	21	8

MPC-NPT

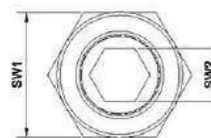
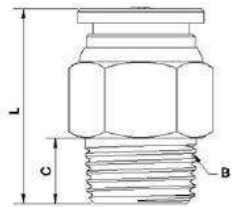

Item Code	Tube OD	NPT		L	SW1	SW2
	Tube φ	B	C			
MPC1/8-N01	1/8	1/8	7.5	19.5	10	2
MPC1/8-N02	1/8	1/4	9	18.5	14	2
MPC5/32-N01	5/32	1/8	7.5	19.5	10	3
MPC5/32-N02	5/32	1/4	9	18.5	14	3
MPC1/4-N01	1/4	1/8	7.5	19.7	12	5
MPC1/4-N02	1/4	1/4	9	20.2	14	5
MPC1/4-N03	1/4	3/8	10	21.2	17	5
MPC1/4-N04	1/4	1/2	13	24.2	21	5
MPC5/16-N01	5/16	1/8	7.5	24	14	5
MPC5/16-N02	5/16	1/4	9	22.5	14	6
MPC5/16-N03	5/16	3/8	10	21.2	17	6
MPC5/16-N04	5/16	1/2	13	24.2	21	6
MPC3/8-N01	3/8	1/8	7.5	26.5	17	5
MPC3/8-N02	3/8	1/4	9	26.5	17	6
MPC3/8-N03	3/8	3/8	10	26.2	17	8
MPC3/8-N04	3/8	1/2	13	24.7	21	8
MPC1/2-N02	1/2	1/4	9	30.2	19	6
MPC1/2-N03	1/2	3/8	10	28.3	19	8
MPC1/2-N04	1/2	1/2	13	28.7	21	8

MPCF-BSPT

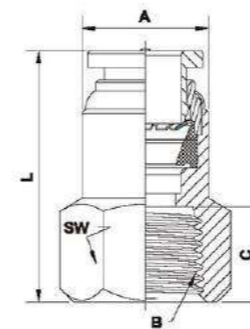

Item Code	Tube OD	BSPT		L	SW	
	Tube φ	A φ	B			
MPCF3-01	3	10.6	1/8	9.5	24.5	12
MPCF3-02	3	10.6	1/4	11	26	17
MPCF4-01	4	10.6	1/8	9.5	24.5	12
MPCF4-02	4	10.6	1/4	11	26	17
MPCF6-01	6	12.4	1/8	9.5	24.7	14
MPCF6-02	6	12.4	1/4	11	26.2	17
MPCF6-03	6	12.4	3/8	12	27.2	19
MPCF6-04	6	12.4	1/2	15	30.2	24
MPCF8-01	8	13.7	1/8	9.5	26	14
MPCF8-02	8	14.6	1/4	11	27.5	17
MPCF8-03	8	14.6	3/8	12	28.5	19
MPCF8-04	8	14.6	1/2	15	29.5	24
MPCF10-01	10	16.8	1/8	9.5	28.4	17
MPCF10-02	10	16.8	1/4	11	29.9	17
MPCF10-03	10	17.6	3/8	12	30.9	19
MPCF10-04	10	17.6	1/2	15	33.9	24
MPCF12-02	12	19.6	1/4	11	32.1	21
MPCF12-03	12	19.6	3/8	12	33.1	21
MPCF12-04	12	19.6	1/2	15	36.1	24

Brass Push Fittings

全铜快插接头

MPCF-NPT

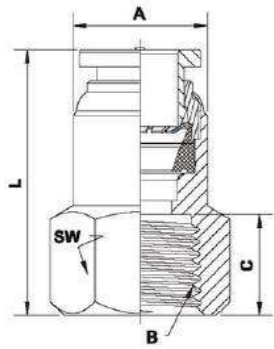

Item Code	Tube OD		NPT		L	SW
	Tube ϕ	A ϕ	B	C		
MPCF1/8-N01	1/8	10.6	1/8	9.5	24.5	12
MPCF1/8-N02	1/8	10.6	1/4	11	26	17
MPCF5/32-N01	5/32	10.6	1/8	9.5	24.5	12
MPCF5/32-N02	5/32	10.6	1/4	11	26	17
MPCF1/4-N01	1/4	12.4	1/8	9.5	24.7	14
MPCF1/4-N02	1/4	12.4	1/4	11	26.2	17
MPCF1/4-N03	1/4	12.4	3/8	12	27.2	19
MPCF1/4-N04	1/4	12.4	1/2	15	30.2	24
MPCF5/16-N01	5/16	13.7	1/8	9.5	26	14
MPCF5/16-N02	5/16	14.6	1/4	11	27.5	17
MPCF5/16-N03	5/16	14.6	3/8	12	28.5	19
MPCF5/16-N04	5/16	14.6	1/2	15	29.5	24
MPCF3/8-N01	3/8	16.8	1/8	9.5	28.4	17
MPCF3/8-N02	3/8	16.8	1/4	11	29.9	17
MPCF3/8-N03	3/8	17.6	3/8	12	30.9	19
MPCF3/8-N04	3/8	17.6	1/2	15	33.9	24
MPCF1/2-N02	1/2	19.6	1/4	11	32.1	21
MPCF1/2-N03	1/2	19.6	3/8	12	33.1	21
MPCF1/2-N04	1/2	19.6	1/2	15	36.1	24

MPCF-BSPP

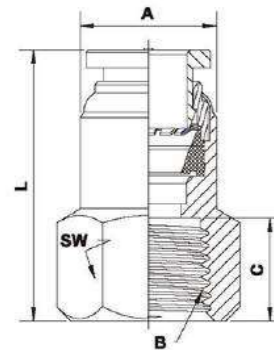

Item Code	Tube OD		BSPP		L	SW
	Tube ϕ	A ϕ	B	C		
MPCF3-G01	3	10.6	1/8	8	23	12
MPCF3-G02	3	10.6	1/4	9	24	17
MPCF4-G01	4	10.6	1/8	8	23	12
MPCF4-G02	4	10.6	1/4	9	24	17
MPCF6-G01	6	12.4	1/8	8	23.2	14
MPCF6-G02	6	12.4	1/4	9	24.2	17
MPCF6-G03	6	12.4	3/8	10	25.2	19
MPCF6-G04	6	12.4	1/2	13	28.2	24
MPCF8-G01	8	13.8	1/8	8	24.5	14
MPCF8-G02	8	14.6	1/4	9	25.5	17
MPCF8-G03	8	14.6	3/8	10	26.5	19
MPCF8-G04	8	14.6	1/2	13	29.5	24
MPCF10-G01	10	16.8	1/8	8	26.9	17
MPCF10-G02	10	16.8	1/4	9	27.9	17
MPCF10-G03	10	17.6	3/8	10	28.9	19
MPCF10-G04	10	17.6	1/2	13	31.9	24
MPCF12-G02	12	19.6	1/4	9	30.1	21
MPCF12-G03	12	19.6	3/8	10	31.1	21
MPCF12-G04	12	19.6	1/2	13	34.1	24

MPOC-BSPT

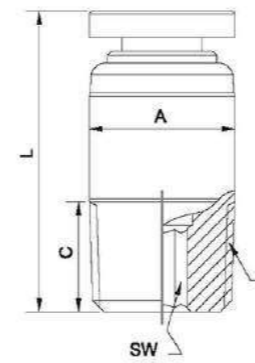

Item Code	Tube OD		BSPT		L	SW
	Tube ϕ	A ϕ	B	C		
MPOC 3-01	3	10	1/8	7.5	19.5	2
MPOC 3-02	3	14	1/4	9	18.5	2
MPOC 4-01	4	10	1/8	7.5	19.5	3
MPOC 4-02	4	14	1/4	9	18.5	3
MPOC 6-01	6	12	1/8	7.5	19.7	5
MPOC 6-02	6	14	1/4	9	20.2	5
MPOC 6-03	6	17	3/8	10	21.2	5
MPOC 6-04	6	22	1/2	13	24.2	5
MPOC 8-01	8	14	1/8	7.5	24	5
MPOC 8-02	8	14	1/4	9	22.5	6
MPOC 8-03	8	17	3/8	10	21.2	6
MPOC 8-04	8	22	1/2	13	24.2	6
MPOC 10-01	10	17	1/8	7.5	26.5	5
MPOC 10-02	10	17	1/4	9	26.5	6
MPOC 10-03	10	17	3/8	10	26.2	8
MPOC 10-04	10	22	1/2	13	26.5	8
MPOC 12-02	12	20	1/4	9	30.7	6
MPOC 12-03	12	20	3/8	10	28.3	8
MPOC 12-04	12	22	1/2	13	26.5	8

MPOC-NPT

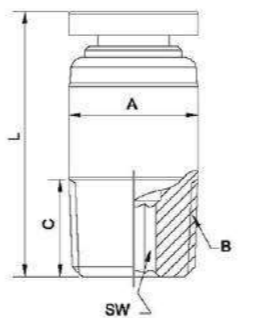

Item Code	Tube OD		NPT		L	SW
	Tube ϕ	A ϕ	B	C		
MPOC 1/8-N01	1/8	10	1/8	7.5	19.5	2
MPOC 1/8-N02	1/8	14	1/4	9	18.5	2
MPOC 5/32-N01	5/32	10	1/8	7.5	19.5	3
MPOC 5/32-N02	5/32	14	1/4	9	18.5	3
MPOC 1/4-N01	1/4	12	1/8	7.5	19.7	5
MPOC 1/4-N02	1/4	14	1/4	9	20.2	5
MPOC 1/4-N03	1/4	17	3/8	10	21.2	5
MPOC 1/4-N04	1/4	22	1/2	13	24.2	5
MPOC 5/16-N01	5/16	14	1/8	7.5	24	5
MPOC 5/16-N02	5/16	14	1/4	9	22.5	6
MPOC 5/16-N03	5/16	17	3/8	10	21.2	6
MPOC 5/16-N04	5/16	22	1/2	13	24.2	6
MPOC 3/8-N01	3/8	17	1/8	7.5	26.5	5
MPOC 3/8-N02	3/8	17	1/4	9	26.5	6
MPOC 3/8-N03	3/8	17	3/8	10	26.2	8
MPOC 3/8-N04	3/8	22	1/2	13	26.5	8
MPOC 1/2-N02	1/2	20	1/4	9	30.7	6
MPOC 1/2-N03	1/2	20	3/8	10	28.3	8
MPOC 1/2-N04	1/2	22	1/2	13	26.5	8

Brass Push Fittings

全铜快插接头

MPOC-M

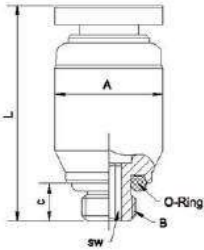

Item Code	Tube OD		B	C	L	SW
	Tube φ	Aφ				
MPOC 3-M5	3	10	M5	3.5	19	2
MPOC 3-M6	3	10	M6	4.5	20	2
MPOC 4-M5	4	10	M5	3.5	19	2
MPOC 4-M6	4	10	M6	4.5	20	2
MPOC 6-M5	6	12	M5	3.5	19.8	2
MPOC 6-M6	6	12	M6	4.5	20.8	2
MPOC 1/8-M5	1/8	10	M5	3.5	19	2
MPOC 1/8-M6	1/8	10	M6	4.5	20	2
MPOC 5/32-M5	5/32	10	M5	3.5	19	2
MPOC 5/32-M6	5/32	10	M6	4.5	20	2
MPOC 1/4-M5	1/4	12	M5	3.5	19.8	2
MPOC 1/4-M6	1/4	12	M6	4.5	20.8	2
MPOC 1/8-U10	1/8	10	UNF10-32	3.5	19	2
MPOC 5/32-U10	5/32	10	UNF10-32	3.5	19	2
MPOC 1/4-U10	1/4	12	UNF10-32	3.5	19.8	2

MPL-NPT

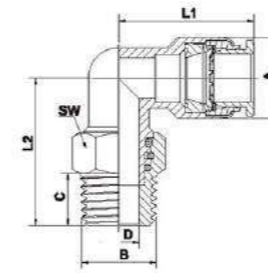

型号	Tube	NPT		C	通气孔		L2	SW
		A	B		D	L1		
MPL1/8-N01	1/8	Φ10	1/8	7.5	Φ4	18.8	20.6	10
MPL1/8-N02	1/8	Φ10	1/4	9	Φ4	18.8	21.1	14
MPL5/32-N01	5/32	Φ10	1/8	7.5	Φ4	18.8	20.6	10
MPL5/32-N02	5/32	Φ10	1/4	9	Φ4	18.8	21.1	14
MPL1/4-N01	1/4	Φ12	1/8	7.5	Φ4	20.4	21	10
MPL1/4-N02	1/4	Φ12	1/4	9	Φ4	20.4	21.5	14
MPL5/16-N01	5/16	Φ14	1/8	7.5	Φ4	23.4	22.5	10
MPL5/16-N02	5/16	Φ14	1/4	9	Φ7	23.4	25.5	14
MPL5/16-N03	5/16	Φ14	3/8	10	Φ7	23.4	25.5	17
MPL5/16-N04	5/16	Φ14	1/2	13	Φ7	23.4	28.5	22
MPL3/8-N01	3/8	Φ17	1/8	7.5	Φ4	27.2	24.5	10
MPL3/8-N02	3/8	Φ17	1/4	9	Φ7	27.2	26	14
MPL3/8-N03	3/8	Φ17	3/8	10	Φ10	27.2	27.5	17
MPL3/8-N04	3/8	Φ17	1/2	13	Φ10	27.2	30.5	22
MPL1/2-N02	1/2	Φ20	1/4	9	Φ7	30.9	28	14
MPL1/2-N03	1/2	Φ20	3/8	10	Φ10	30.9	27.5	17
MPL1/2-N04	1/2	Φ20	1/2	13	Φ10	30.9	30.5	22

MPL-BSPT

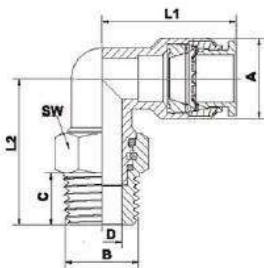

型号	Tube	BSPT		C	通气孔		L2	SW
		A	B		D	L1		
MPL3-01	3	Φ10	1/8	7.5	Φ4	18.8	20.6	10
MPL3-02	3	Φ10	1/4	9	Φ4	18.8	21.1	14
MPL4-01	4	Φ10	1/8	7.5	Φ4	18.8	20.6	10
MPL4-02	4	Φ10	1/4	9	Φ4	18.8	21.1	14
MPL6-01	6	Φ12	1/8	7.5	Φ4	20.4	21	10
MPL6-02	6	Φ12	1/4	9	Φ4	20.4	21.5	14
MPL8-01	8	Φ14	1/8	7.5	Φ4	23.4	22.5	10
MPL8-02	8	Φ14	1/4	9	Φ7	23.4	25.5	14
MPL8-03	8	Φ14	3/8	10	Φ7	23.4	25.5	17
MPL8-04	8	Φ14	1/2	13	Φ7	23.4	28.5	21
MPL10-01	10	Φ17	1/8	7.5	Φ4	27.2	24.5	10
MPL10-02	10	Φ17	1/4	9	Φ7	27.2	26	14
MPL10-03	10	Φ17	3/8	10	Φ10	27.2	27.5	17
MPL10-04	10	Φ17	1/2	13	Φ10	27.2	30.5	21
MPL12-02	12	Φ20	1/4	9	Φ7	30.9	28	14
MPL12-03	12	Φ20	3/8	10	Φ10	30.9	27.5	17
MPL12-04	12	Φ20	1/2	13	Φ10	30.9	30.5	21

MPL-M

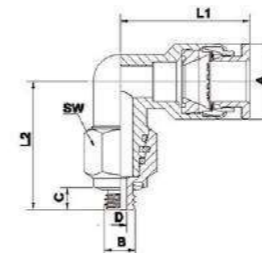

型号	TUBE OD	Tube	A	B	C	通气孔		SW
						D	L1	
MPL3-M5	3	Φ10	M5*0.8	3.5	Φ2	18.8	19.8	10
MPL3-M6	3	Φ10	M6*1	4.5	Φ2.5	18.8	20.8	10
MPL4-M5	4	Φ10	M5*0.8	3.5	Φ2	18.8	19.8	10
MPL4-M6	4	Φ10	M6*1	4.5	Φ2.5	18.8	20.8	10
MPL6-M5	6	Φ12	M5*0.8	3.5	Φ2	20.4	20.2	10
MPL6-M6	6	Φ12	M6*1	4.5	Φ2.5	20.4	21.2	10
MPL1/8-M5	1/8	Φ10	M5*0.8	3.5	Φ2	18.8	19.8	10
MPL1/8-M6	1/8	Φ10	M6*1	4.5	Φ2.5	18.8	20.8	10
MPL5/32-M5	5/32	Φ10	M5*0.8	3.5	Φ2	18.8	19.8	10
MPL5/32-M6	5/32	Φ10	M6*1	4.5	Φ2.5	18.8	20.8	10
MPL1/4-M5	1/4	Φ12	M5*0.8	3.5	Φ2	20.4	20.2	10
MPL1/4-M6	1/4	Φ12	M6*1	4.5	Φ2.5	20.4	21.2	10
MPL1/8-U10	1/8	Φ10	UNF10-32	3.5	Φ2	18.8	19.8	10
MPL5/32-U10	5/32	Φ10	UNF10-32	3.5	Φ2	18.8	19.8	10
MPL1/4-U10	1/4	Φ12	UNF10-32	3.5	Φ2	20.4	20.2	10

Brass Push Fittings

全铜快插接头

MPL-BSPP

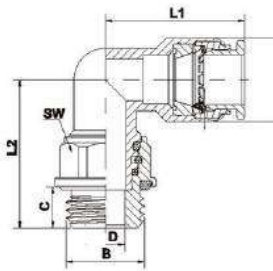

型号	TUBE OD	A	BSPP	C	通气孔	L1	L2	SW
MPL3-G01	3	Φ10	1/8	5.5	V	18.8	20.6	12
MPL3-G02	3	Φ10	1/4	6.9	Φ4	18.8	20.5	14
MPL4-G01	4	Φ10	1/8	5.5	Φ4	18.8	20.6	12
MPL4-G02	4	Φ10	1/4	6.9	Φ4	18.8	20.5	14
MPL6-G01	6	Φ12	1/8	5.5	Φ4	20.4	21	12
MPL6-G02	6	Φ12	1/4	6.9	Φ4	20.4	20.9	14
MPL8-G01	8	Φ14	1/8	5.5	Φ4	23.4	22.5	12
MPL8-G02	8	Φ14	1/4	6.9	Φ7	23.4	24.9	14
MPL8-G03	8	Φ14	3/8	8.2	Φ7	23.4	24.2	17
MPL8-G04	8	Φ14	1/2	9.2	Φ7	23.4	27.2	17
MPL10-G01	10	Φ17	1/8	5.5	Φ4	27.2	24.5	12
MPL10-G02	10	Φ17	1/4	6.9	Φ7	27.2	25.4	14
MPL10-G03	10	Φ17	3/8	8.2	Φ10	27.2	28.7	17
MPL10-G04	10	Φ17	1/2	9.2	Φ10	27.2	29.2	17
MPL12-G02	12	Φ20	1/4	6.9	Φ7	30.9	27.4	14
MPL12-G03	12	Φ20	3/8	8.2	Φ10	30.9	28.7	17
MPL12-G04	12	Φ20	1/2	9.2	Φ10	30.9	29.2	17

MPLF-BSPT

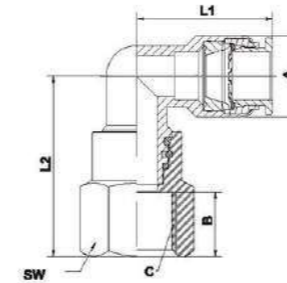

Item Code	tube	A	B	BSPT	C	L1	L2	SW
MPLF3-01	3	10	8	1/8	18.8	24.1	14	
MPLF3-02	3	10	11	1/4	18.8	27.1	17	
MPLF4-01	4	10	8	1/8	18.8	24.1	14	
MPLF4-02	4	10	11	1/4	18.8	27.1	17	
MPLF6-01	6	12	8	1/8	20.4	24.5	14	
MPLF6-02	6	12	11	1/4	20.4	27.5	17	
MPLF8-01	8	14	8	1/8	23.4	26	14	
MPLF8-02	8	14	11	1/4	23.4	28	17	
MPLF8-03	8	14	12	3/8	23.4	28	19	
MPLF8-04	8	14	15	1/2	23.4	28	24	
MPLF10-01	10	17	8	1/8	27.2	28	14	
MPLF10-02	10	17	11	1/4	27.2	31.5	17	
MPLF10-03	10	17	12	3/8	27.2	34	19	
MPLF10-04	10	17	15	1/2	27.2	37	24	
MPLF12-02	12	20	11	1/4	30.9	33.5	17	
MPLF12-03	12	20	12	3/8	30.9	34	19	
MPLF12-04	12	20	15	1/2	30.9	37	24	

MPLF-M

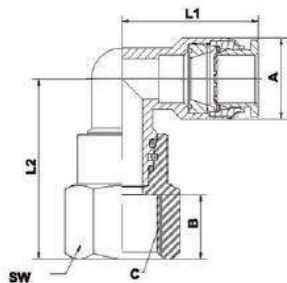

Item Code	tube	A	B	C	L1	L2	SW
MPLF3-M5	3	10	7	M5	18.8	23.1	12
MPLF3-M6	3	10	7	M6	18.8	23.1	12
MPLF4-M5	4	10	7	M5	18.8	23.1	12
MPLF4-M6	4	10	7	M6	18.8	23.1	12
MPLF6-M5	6	12	7	M5	20.4	23.5	12
MPLF6-M6	6	12	7	M6	20.4	23.5	12
MPLF5/32-M5	5/32	10	7	M5	18.8	23.1	12
MPLF5/32-M6	5/32	10	7	M6	18.8	23.1	12
MPLF1/4-M5	1/4	12	7	M5	20.4	23.5	12
MPLF1/4-M6	1/4	12	7	M6	20.4	23.5	12
MPLF5/32-U10	5/32	10	7	10-32UNF	18.8	23.1	12
MPLF1/4-U10	5/32	12	7	10-32UNF	20.4	23.5	12

MPLF-NPT

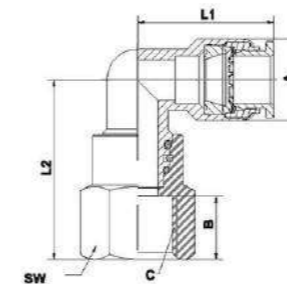

型号	tube	A	B	NPT	C	L1	L2	SW
MPLF1/8-N01	1/8	10	8	1/8	18.8	24.1	14	
MPLF1/8-N02	1/8	10	11	1/4	18.8	27.1	17	
MPLF5/32-N01	5/32	10	8	1/8	18.8	24.1	14	
MPLF5/32-N02	5/32	10	11	1/4	18.8	27.1	17	
MPLF1/4-N01	1/4	12	8	1/8	20.4	24.5	14	
MPLF1/4-N02	1/4	12	11	1/4	20.4	27.5	17	
MPLF5/16-N01	5/16	14	8	1/8	23.4	26	14	
MPLF5/16-N02	5/16	14	11	1/4	23.4	28	17	
MPLF5/16-N03	5/16	14	12	3/8	23.4	28	19	
MPLF5/16-N04	5/16	14	15	1/2	23.4	28	24	
MPLF3/8-N01	3/8	17	8	1/8	27.2	28	14	
MPLF3/8-N02	3/8	17	11	1/4	27.2	31.5	17	
MPLF3/8-N03	3/8	17	12	3/8	27.2	34	19	
MPLF3/8-N04	3/8	17	15	1/2	27.2	37	24	
MPLF1/2-N02	1/2	20	11	1/4	30.9	33.5	17	
MPLF1/2-N03	1/2	20	12	3/8	30.9	34	19	
MPLF1/2-N04	1/2	20	15	1/2	30.9	37	24	

Brass Push Fittings

全铜快插接头

MPLF-BSPP

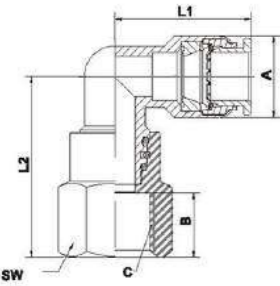

型号	tube	A	B	BSPP		L1	L2	SW
MPLF3-G01	3	10	8	1/8		18.8	24.1	14
MPLF3-G02	3	10	11	1/4		18.8	27.1	17
MPLF4-G01	4	10	8	1/8		18.8	24.1	14
MPLF4-G02	4	10	11	1/4		18.8	27.1	17
MPLF6-G01	6	12	8	1/8		20.4	24.5	14
MPLF6-G02	6	12	11	1/4		20.4	27.5	17
MPLF8-G01	8	14	8	1/8		23.4	26	14
MPLF8-G02	8	14	11	1/4		23.4	28	17
MPLF8-G03	8	14	12	3/8		23.4	28	19
MPLF8-G04	8	14	15	1/2		23.4	28	24
MPLF10-G01	10	17	8	1/8		27.2	28	14
MPLF10-G02	10	17	11	1/4		27.2	31.5	17
MPLF10-G03	10	17	12	3/8		27.2	34	19
MPLF10-G04	10	17	15	1/2		27.2	37	24
MPLF12-G02	12	20	11	1/4		30.9	33.5	17
MPLF12-G03	12	20	12	3/8		30.9	34	19
MPLF12-G04	12	20	15	1/2		30.9	37	24

MPT-NPT

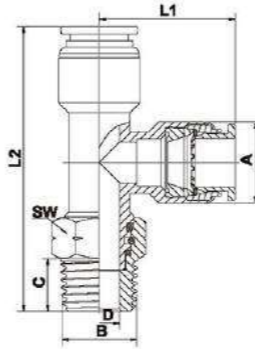

型号	Tube	A	B	C	通气孔	L1	L2	SW
MPT1/8-N01	1/8	Φ10	1/8	7.5	Φ4	37.6	20.6	10
MPT1/8-N02	1/8	Φ10	1/4	9	Φ4	37.6	21.1	14
MPT5/32-N01	5/32	Φ10	1/8	7.5	Φ4	37.6	20.6	10
MPT5/32-N02	5/32	Φ10	1/4	9	Φ4	37.6	21.1	14
MPT1/4-N01	1/4	Φ12	1/8	7.5	Φ4	40.8	21	10
MPT1/4-N02	1/4	Φ12	1/4	9	Φ4	40.8	21.5	14
MPT5/16-N01	5/16	Φ14	1/8	7.5	Φ4	46.8	22.5	10
MPT5/16-N02	5/16	Φ14	1/4	9	Φ7	46.8	25.5	14
MPT5/16-N03	5/16	Φ14	3/8	10	Φ7	46.8	25.5	17
MPT5/16-N04	5/16	Φ14	1/2	13	Φ7	46.8	28.5	21
MPT3/8-N01	3/8	Φ17	1/8	7.5	Φ4	54.4	24.5	10
MPT3/8-N02	3/8	Φ17	1/4	9	Φ7	54.4	26	14
MPT3/8-N03	3/8	Φ17	3/8	10	Φ10	54.4	27.5	17
MPT3/8-N04	3/8	Φ17	1/2	13	Φ10	54.4	30.5	21
MPT1/2-N02	1/2	Φ20	1/4	9	Φ7	61.8	28	14
MPT1/2-N03	1/2	Φ20	3/8	10	Φ10	61.8	27.5	17
MPT1/2-N04	1/2	Φ20	1/2	13	Φ10	61.8	30.5	21

MPT-BSPT

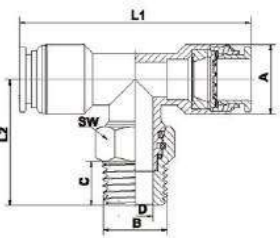

型号	Tube	A	BSPT	C	通气孔	L1	L2	SW
MPT3-01	3	Φ10	1/8	7.5	Φ4	37.6	20.6	10
MPT3-02	3	Φ10	1/4	9	Φ4	37.6	21.1	14
MPT4-01	4	Φ10	1/8	7.5	Φ4	37.6	20.6	10
MPT4-02	4	Φ10	1/4	9	Φ4	37.6	21.1	14
MPT6-01	6	Φ12	1/8	7.5	Φ4	40.8	21	10
MPT6-02	6	Φ12	1/4	9	Φ4	40.8	21.5	14
MPT8-01	8	Φ14	1/8	7.5	Φ4	46.8	22.5	10
MPT8-02	8	Φ14	1/4	9	Φ7	46.8	25.5	14
MPT8-03	8	Φ14	3/8	10	Φ7	46.8	25.5	17
MPT8-04	8	Φ14	1/2	13	Φ7	46.8	28.5	21
MPT10-01	10	Φ17	1/8	7.5	Φ4	54.4	24.5	10
MPT10-02	10	Φ17	1/4	9	Φ7	54.4	26	14
MPT10-03	10	Φ17	3/8	10	Φ10	54.4	27.5	17
MPT10-04	10	Φ17	1/2	13	Φ10	54.4	30.5	21
MPT12-02	12	Φ20	1/4	9	Φ7	61.8	28	14
MPT12-03	12	Φ20	3/8	10	Φ10	61.8	27.5	17
MPT12-04	12	Φ20	1/2	13	Φ10	61.8	30.5	21

MPT-BSPP

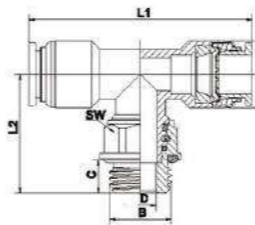

型号	管子外径	A	BSPP	C	通气孔	L1	L2	SW
MPT3-G01	3	Φ10	1/8	5.5	Φ4	37.6	20.6	12
MPT3-G02	3	Φ10	1/4	6.9	Φ4	37.6	20.5	14
MPT4-G01	4	Φ10	1/8	5.5	Φ4	37.6	20.6	12
MPT4-G02	4	Φ10	1/4	6.9	Φ4	37.6	20.5	14
MPT6-G01	6	Φ12	1/8	5.5	Φ4	40.8	21	12
MPT6-G02	6	Φ12	1/4	6.9	Φ4	40.8	20.9	14
MPT8-G01	8	Φ14	1/8	5.5	Φ4	46.8	22.5	12
MPT8-G02	8	Φ14	1/4	6.9	Φ7	46.8	24.9	14
MPT8-G03	8	Φ14	3/8	8.2	Φ7	46.8	24.2	17
MPT8-G04	8	Φ14	1/2	9.2	Φ7	46.8	27.2	17
MPT10-G01	10	Φ17	1/8	5.5	Φ4	54.4	24.5	12
MPT10-G02	10	Φ17	1/4	6.9	Φ7	54.4	25.4	14
MPT10-G03	10	Φ17	3/8	8.2	Φ10	54.4	28.7	17
MPT10-G04	10	Φ17	1/2	9.2	Φ10	54.4	29.2	17
MPT12-G02	12	Φ20	1/4	6.9	Φ7	61.8	27.4	14
MPT12-G03	12	Φ20	3/8	8.2	Φ10	61.8	28.7	17
MPT12-G04	12	Φ20	1/2	9.2	Φ10	61.8	29.2	17

Brass Push Fittings

全铜快插接头

MPT-M

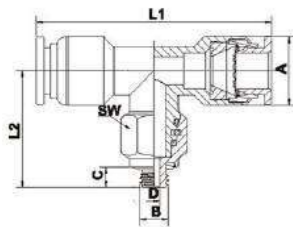

型号	管子外径 Tube	A	B	C	通气孔 D	L1	L2	SW
MPT3-M5	3	Φ10	M5*0.8	3.5	Φ2	37.6	19.8	10
MPT3-M6	3	Φ10	M6*1	4.5	Φ2.5	37.6	20.8	10
MPT4-M5	4	Φ10	M5*0.8	3.5	Φ2	37.6	19.8	10
MPT4-M6	4	Φ10	M6*1	4.5	Φ2.5	37.6	20.8	10
MPT6-M5	6	Φ12	M5*0.8	3.5	Φ2	40.8	20.2	10
MPT6-M6	6	Φ12	M6*1	4.5	Φ2.5	40.8	21.2	10
MPT1/8-M5	1/8	Φ10	M5*0.8	3.5	Φ2	37.6	19.8	10
MPT1/8-M6	1/8	Φ10	M6*1	4.5	Φ2.5	37.6	20.8	10
MPT5/32-M5	5/32	Φ10	M5*0.8	3.5	Φ2	37.6	19.8	10
MPT5/32-M6	5/32	Φ10	M6*1	4.5	Φ2.5	37.6	20.8	10
MPT1/4-M5	1/4	Φ12	M5*0.8	3.5	Φ2	40.8	20.2	10
MPT1/4-M6	1/4	Φ12	M6*1	4.5	Φ2.5	40.8	21.2	10
MPT1/8-U10	U10	Φ10	UNF10-32	3.5	Φ2	37.6	19.8	10
MPT5/32-U10	U10	Φ10	UNF10-32	3.5	Φ2	37.6	19.8	10
MPT1/4-U10	U10	Φ12	UNF10-32	3.5	Φ2	40.8	20.2	10

MPST-BSPP

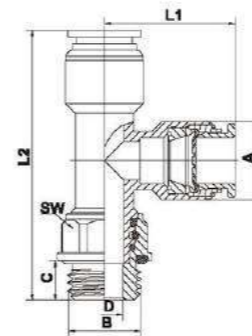

型号	管子外径 Tube	A	BSPP B	C	通气孔 D	L1	L2	SW
MPST3-G01	3	Φ10	1/8	5.5	Φ4	18.8	39.4	12
MPST3-G02	3	Φ10	1/4	6.9	Φ4	18.8	39.3	14
MPST4-G01	4	Φ10	1/8	5.5	Φ4	18.8	39.4	12
MPST4-G02	4	Φ10	1/4	6.9	Φ4	18.8	39.3	14
MPST6-G01	6	Φ12	1/8	5.5	Φ4	20.4	41.4	12
MPST6-G02	6	Φ12	1/4	6.9	Φ4	20.4	41.3	14
MPST8-G01	8	Φ14	1/8	5.5	Φ4	23.4	45.9	12
MPST8-G02	8	Φ14	1/4	6.9	Φ7	23.4	48.3	14
MPST8-G03	8	Φ14	3/8	8.2	Φ7	23.4	47.6	17
MPST8-G04	8	Φ14	1/2	9.2	Φ7	23.4	50.6	17
MPST10-G01	10	Φ17	1/8	5.5	Φ4	27.2	51.7	12
MPST10-G02	10	Φ17	1/4	6.9	Φ7	27.2	52.6	14
MPST10-G03	10	Φ17	3/8	8.2	Φ10	27.2	55.9	17
MPST10-G04	10	Φ17	1/2	9.2	Φ10	27.2	56.4	17
MPST12-G02	12	Φ20	1/4	6.9	Φ7	30.9	58.3	14
MPST12-G03	12	Φ20	3/8	8.2	Φ10	30.9	59.6	17
MPST12-G04	12	Φ20	1/2	9.2	Φ10	30.9	60.1	17

MPST-BSPT

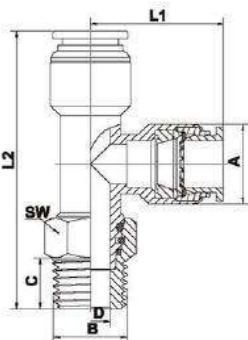

型号	管子外径 Tube	A	BSPT B	C	通气孔 D	L1	L2	SW
MPST3-01	3	Φ10	1/8	7.5	Φ4	18.8	39.4	10
MPST3-02	3	Φ10	1/4	9	Φ4	18.8	39.9	14
MPST4-01	4	Φ10	1/8	7.5	Φ4	18.8	39.4	10
MPST4-02	4	Φ10	1/4	9	Φ4	18.8	39.9	14
MPST6-01	6	Φ12	1/8	7.5	Φ4	20.4	41.4	10
MPST6-02	6	Φ12	1/4	9	Φ4	20.4	41.9	14
MPST8-01	8	Φ14	1/8	7.5	Φ4	23.4	45.9	10
MPST8-02	8	Φ14	1/4	9	Φ7	23.4	48.9	14
MPST8-03	8	Φ14	3/8	10	Φ7	23.4	48.9	17
MPST8-04	8	Φ14	1/2	13	Φ7	23.4	51.9	21
MPST10-01	10	Φ17	1/8	7.5	Φ4	27.2	51.7	10
MPST10-02	10	Φ17	1/4	9	Φ7	27.2	53.2	14
MPST10-03	10	Φ17	3/8	10	Φ10	27.2	54.7	17
MPST10-04	10	Φ17	1/2	13	Φ10	27.2	57.7	21
MPST12-02	12	Φ20	1/4	9	Φ7	30.9	58.9	14
MPST12-03	12	Φ20	3/8	10	Φ10	30.9	58.4	17
MPST12-04	12	Φ20	1/2	13	Φ10	30.9	61.4	21

MPST-NPT

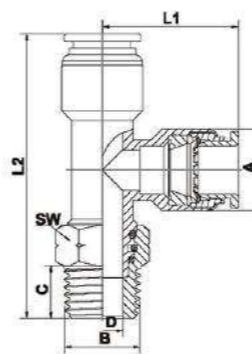

型号	管子外径 Tube	A	NPT B	C	通气孔 D	L1	L2	SW
MPST1/8-N01	1/8	Φ10	1/8	7.5	Φ4	18.8	39.4	10
MPST1/8-N02	1/8	Φ10	1/4	9	Φ4	18.8	39.9	14
MPST5/32-N01	5/32	Φ10	1/8	7.5	Φ4	18.8	39.4	10
MPST5/32-N02	5/32	Φ10	1/4	9	Φ4	18.8	39.9	14
MPST1/4-N01	1/4	Φ12	1/8	7.5	Φ4	20.4	41.4	10
MPST1/4-N02	1/4	Φ12	1/4	9	Φ4	20.4	41.9	14
MPST5/16-N01	5/16	Φ14	1/8	7.5	Φ4	23.4	45.9	10
MPST5/16-N02	5/16	Φ14	1/4	9	Φ7	23.4	48.9	14
MPST5/16-N03	5/16	Φ14	3/8	10	Φ7	23.4	48.9	17
MPST5/16-N04	5/16	Φ14	1/2	13	Φ7	23.4	51.9	22
MPST3/8-N01	3/8	Φ17	1/8	7.5	Φ4	27.2	51.7	10
MPST3/8-N02	3/8	Φ17	1/4	9	Φ7	27.2	53.2	14
MPST3/8-N03	3/8	Φ17	3/8	10	Φ10	27.2	54.7	17
MPST3/8-N04	3/8	Φ17	1/2	13	Φ10	27.2	57.7	22
MPST1/2-N02	1/2	Φ20	1/4	9	Φ7	30.9	58.9	14
MPST1/2-N03	1/2	Φ20	3/8	10	Φ10	30.9	58.4	17
MPST1/2-N04	1/2	Φ20	1/2	13	Φ10	30.9	61.4	22

Brass Push Fittings

全铜快插接头

MPST-M

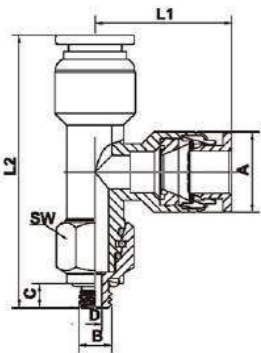

型号	管子外径 Tube	A	B	C	通气孔 D	L1	L2	SW
MPST3-M5	3	Φ10	M5*0.8	3.5	Φ2	18.8	38.6	10
MPST3-M6	3	Φ10	M6*1	4.5	Φ2.5	18.8	39.6	10
MPST4-M5	4	Φ10	M5*0.8	3.5	Φ2	18.8	38.6	10
MPST4-M6	4	Φ10	M6*1	4.5	Φ2.5	18.8	39.6	10
MPST6-M5	6	Φ12	M5*0.8	3.5	Φ2	20.4	40.6	10
MPST6-M6	6	Φ12	M6*1	4.5	Φ2.5	20.4	41.6	10
MPST1/8-M5	1/8	Φ10	M5*0.8	3.5	Φ2	18.8	38.6	10
MPST1/8-M6	1/8	Φ10	M6*1	4.5	Φ2.5	18.8	39.6	10
MPST5/32-M5	5/32	Φ10	M5*0.8	3.5	Φ2	18.8	38.6	10
MPST5/32-M6	5/32	Φ10	M6*1	4.5	Φ2.5	18.8	39.6	10
MPST1/4-M5	1/4	Φ12	M5*0.8	3.5	Φ2	20.4	40.6	10
MPST1/4-M6	1/4	Φ12	M6*1	4.5	Φ2.5	20.4	41.6	10
MPST1/8-U10	1/8	Φ10	UNF10-32	3.5	Φ2	18.8	38.6	10
MPST5/32-U10	5/32	Φ10	UNF10-32	3.5	Φ2	18.8	38.6	10
MPST1/4-U10	1/4	Φ12	UNF10-32	3.5	Φ2	20.4	40.6	10

MPMF-BSP

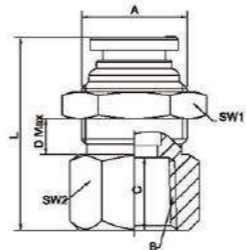

Item Code	Tube OD Tube φ	A	BSP	C	Max D	L	SW 1	SW 2
MPMF3-G01	3	M12*1	1/8	8	4.5	23.5	14	14
MPMF3-G02	3	M12*1	1/4	9	4.5	24.5	14	17
MPMF4-G01	4	M12*1	1/8	8	4.5	23.5	14	14
MPMF4-G02	4	M12*1	1/4	9	4.5	24.5	14	17
MPMF6-G01	6	M14*1	1/8	8	6	24.2	17	17
MPMF6-G02	6	M14*1	1/4	9	6	26.7	17	17
MPMF6-G03	6	M14*1	3/8	10	6	27.7	17	19
MPMF6-G04	6	M14*1	1/2	13	6	30.7	17	24
MPMF8-G01	8	M16*1	1/8	8	6	24.2	19	17
MPMF8-G02	8	M16*1	1/4	9	6	25.7	19	17
MPMF8-G03	8	M16*1	3/8	10	6	27.7	19	19
MPMF8-G04	8	M16*1	1/2	13	6	30.7	19	24
MPMF10-G01	10	M18*1	1/8	8	10.5	27.7	21	19
MPMF10-G02	10	M18*1	1/4	9	10.5	28.2	21	19
MPMF10-G03	10	M18*1	3/8	10	10.5	31.7	21	19
MPMF10-G04	10	M18*1	1/2	13	10.5	35.2	21	24
MPMF12-G02	12	M22*1	1/4	9	12	30	24	24
MPMF12-G03	12	M22*1	3/8	10	12	31	24	24
MPMF12-G04	12	M22*1	1/2	13	12	36.5	24	24

MPMF-BSPT

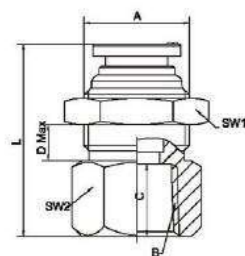

Item Code	Tube OD Tube φ	A	BSPT	C	Max D	L	SW 1	SW 2
MPMF3-01	3	M12*1	1/8	9.5	4.5	25	14	14
MPMF3-02	3	M12*1	1/4	11	4.5	26.5	14	17
MPMF4-01	4	M12*1	1/8	9.5	4.5	25	14	14
MPMF4-02	4	M12*1	1/4	11	4.5	26.5	14	17
MPMF6-01	6	M14*1	1/8	9.5	6	25.7	17	17
MPMF6-02	6	M14*1	1/4	11	6	28.7	17	17
MPMF6-03	6	M14*1	3/8	12	6	29.7	17	19
MPMF6-04	6	M14*1	1/2	15	6	32.7	17	24
MPMF8-01	8	M16*1	1/8	9.5	6	25.7	19	17
MPMF8-02	8	M16*1	1/4	11	6	27.7	19	17
MPMF8-03	8	M16*1	3/8	12	6	29.7	19	19
MPMF8-04	8	M16*1	1/2	15	6	32.7	19	24
MPMF10-01	10	M18*1	1/8	9.5	10.5	29.2	21	19
MPMF10-02	10	M18*1	1/4	11	10.5	30.2	21	19
MPMF10-03	10	M18*1	3/8	12	10.5	33.7	21	19
MPMF10-04	10	M18*1	1/2	15	10.5	37.2	21	24
MPMF12-02	12	M22*1	1/4	11	12	32	24	24
MPMF12-03	12	M22*1	3/8	12	12	33	24	24
MPMF12-04	12	M22*1	1/2	15	12	38.5	24	24

MPMF-NPT

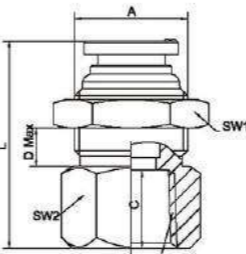

Item Code	Tube OD Tube φ	A	NPT	C	Max D	L	SW 1	SW 2
MPMF1/8-N01	1/8	M12*1	1/8	9.5	4.5	25	14	14
MPMF1/8-N02	1/8	M12*1	1/4	11	4.5	26.5	14	17
MPMF5/32-N01	5/32	M12*1	1/8	9.5	4.5	25	14	14
MPMF5/32-N02	5/32	M12*1	1/4	11	4.5	26.5	14	17
MPMF1/4-N01	1/4	M14*1	1/8	9.5	6	25.7	17	17
MPMF1/4-N02	1/4	M14*1	1/4	11	6	28.7	17	17
MPMF1/4-N03	1/4	M14*1	3/8	12	6	29.7	17	19
MPMF1/4-N04	1/4	M14*1	1/2	15	6	32.7	17	24
MPMF5/16-N01	5/16	M16*1	1/8	9.5	6	25.7	19	17
MPMF5/16-N02	5/16	M16*1	1/4	11	6	27.7	19	17
MPMF5/16-N03	5/16	M16*1	3/8	12	6	29.7	19	19
MPMF5/16-N04	5/16	M16*1	1/2	15	6	32.7	19	24
MPMF3/8-N01	3/8	M18*1	1/8	9.5	10.5	29.2	21	19
MPMF3/8-N02	3/8	M18*1	1/4	11	10.5	30.2	21	19
MPMF3/8-N03	3/8	M18*1	3/8	12	10.5	33.7	21	19
MPMF3/8-N04	3/8	M18*1	1/2	15	10.5	37.2	21	24
MPMF1/2-N03	1/2	M22*1	1/4	11	12	32	24	24
MPMF1/2-N02	1/2	M22*1	3/8	12	12	33	24	24
MPMF1/2-N04	1/2	M22*1	1/2	15	12	38.5	24	24

Brass Push Fittings

全铜快插接头

MPUC



管子外径			
型号	Tube	A	L
MPUC3	3	10	31
MPUC4	4	10	31
MPUC6	6	12	31.4
MPUC8	8	14	34.8
MPUC10	10	17	39.4
MPUC12	12	20	43

管子外径			
型号	Tube	A	L
MPUC1/8	1/8	10	31
MPUC5/32	5/32	10	31
MPUC1/4	1/4	12	31.4
MPUC5/16	5/16	14	34.8
MPUC3/8	3/8	17	39.4
MPUC1/2	1/2	20	43

MPG



Item Code	Tube OD		A	B	L
	Tube				
MPG6-4	6	4	12	10	31.2
MPG8-6	8	6	14	12	33.1
MPG10-8	10	8	17	14	37.1
MPG12-10	12	10	20	17	41.2

Item Code	Tube OD		A	B	L
	Tube				
MPG1/4-5/32	1/4	5/32	12	10	31.2
MPG5/16-1/4	5/16	1/4	14	12	33.1
MPG3/8-5/16	3/8	5/16	17	14	37.1
MPG1/2-3/8	1/2	3/8	20	17	41.2

MPUL

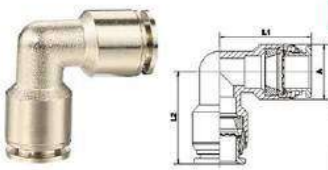

管子外径				
型号	Tube	A	L1	L2
MPUL3	3	10	18.8	18.8
MPUL4	4	10	18.8	18.8
MPUL6	6	12	20.4	20.4
MPUL8	8	14	23.4	23.4
MPUL10	10	17	27.2	27.2
MPUL12	12	20	30.9	30.9

管子外径				
型号	Tube	A	L1	L2
MPUL1/8	1/8	10	18.8	18.8
MPUL5/32	5/32	10	18.8	18.8
MPUL1/4	1/4	12	20.4	20.4
MPUL5/16	5/16	14	23.4	23.4
MPUL3/8	3/8	17	27.2	27.2
MPUL1/2	1/2	20	30.9	30.9

MPGJ



Item Code	A Φ	B Φ	C Φ	L
MPGJ6-4	6	4	10	31.8
MPGJ8-6	8	6	12	33
MPGJ8-4	8	4	10	32.8
MPGJ10-8	10	8	14	38.3
MPGJ10-6	10	6	12	36.5
MPGJ10-4	10	4	10	33.3
MPGJ12-10	12	10	17	43.7
MPGJ12-8	12	8	14	41.9
MPGJ12-6	12	6	12	39

Item Code	A Φ	B Φ	C Φ	L
MPGJ1/4-5/32	6	4	10	31.8
MPGJ5/16-1/4	8	6	12	33
MPGJ5/16-5/32	8	4	10	32.8
MPGJ3/8-5/16	10	8	14	38.3
MPGJ3/8-1/4	10	6	12	36.5
MPGJ3/8-5/32	10	4	10	33.3
MPGJ1/2-3/8	12	10	17	43.7
MPGJ1/2-5/16	12	8	14	41.9
MPGJ1/2-1/4	12	6	12	39

MPUT



管子外径				
型号	Tube	A	L1	L2
MPUT3	3	10	37.6	18.8
MPUT4	4	10	37.6	18.8
MPUT6	6	12	40.8	20.4
MPUT8	8	14	46.8	23.4
MPUT10	10	17	54.4	27.2
MPUT12	12	20	61.8	30.9

管子外径				
型号	Tube	A	L1	L2
MPUT1/8	1/8	10	37.6	18.8
MPUT5/32	5/32	10	37.6	18.8
MPUT1/4	1/4	12	40.8	20.4
MPUT5/16	5/16	14	46.8	23.4
MPUT3/8	3/8	17	54.4	27.2
MPUT1/2	1/2	20	61.8	30.9

MPP



Item Code	A Φ	L
MPP3	3	25
MPP4	4	25
MPP6	6	30
MPP8	8	35
MPP10	10	40.5
MPP12	12	44

Item Code	A Φ	L
MPP1/8	1/8	25
MPP5/32	5/32	25
MPP1/4	1/4	30
MPP5/16	5/16	35
MPP3/8	3/8	40.5
MPP1/2	1/2	44

MPMM

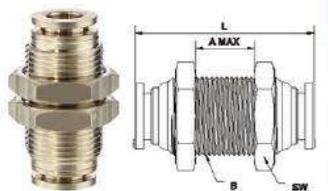

Item Code	Tube OD	THICKNESS			
	Tube φ	A (max)	L	B	SW
MPMM3	3	13	30	M12x1	14
MPMM4	4	13	30	M12x1	14
MPMM6	6	13	31.4	M14x1	17
MPMM8	8	15	33.4	M16x1	19
MPMM10	10	18	37.4	M18x1	21
MPMM12	12	22	43.4	M22x1	24

Item Code	Tube φ	A(max)	L	B	SW
MPMM1/8	1/8	13	30	M12x1	14
MPMM5/32	5/32	13	30	M12x1	14
MPMM1/4	1/4	13	31.4	M14x1	17
MPMM5/16	5/16	15	33.4	M16x1	19
MPMM3/8	3/8	18	37.4	M18x1	21
MPMM1/2	1/2	22	43.4	M22x1	24